

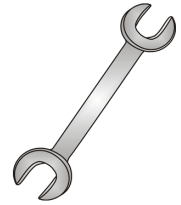

Tow-Trust Towbars

Important: Please read General Notes overleaf before fitting



Issue 7

TDAC1 DACIA DUSTER 2010>

Item	Qty	Description	Item	Qty	Description
A	1	Crossmember	E	2	M16 x 50 Bolts, Nuts & S/P Washers
B	2	Side Arms	F	4	M10 x 90 Bolts, Nuts & S/P Washers
C	1	Extension	G	4	M10 x 35 Bolts, 2 Nuts & 4 S/P Washers
D	4	19mm x 57mm Spacer Tubes	H	4	M12 x 40 Bolts & Nyloc Nuts
			J	2	M10 Clamp Plates
			K	12	10 x 25 Flat Washers
			L	4	12 x 25 Flat Washers

TOWBAR INSTALLATION:

- 2018> ONLY:** Remove rear light clusters, Remove rear bumper, four fixings under each light cluster, four fixings along lower edge and three fixings in each wheel arch, one tip fixing either side.
- Lower the spare wheel on vehicles fitted with a spare wheel cage under the vehicle only.
- Lower the exhaust silencer and support to prevent damage.
- Remove the exhaust heat shield to gain access to the Towbar mounting points.
- Cut the rear bumper to the sketch details below.
- Locate the Towbar mounting points either side of the vehicle and clean both faces of each chassis rails.
- Using Item F with Item K fix items B to the inside face of each chassis member ensuring Item D is located inside each mounting point and Item J is on the outside face. Item J is optional and you can use Item K and nuts supplied with Item F if you find this easier.
- Using Item G with Item K fix Item A between Items B.
- Using Items H with Items L fix Item C to Item A.
- Using Item E fix your desired ball bracket and wiring plate (not supplied in this kit) to Item C.
- Fully tighten all fixings ensuring the Towbar is rigid, square and secure.
- Refit exhaust heat shield and rehang the exhaust silencer.
- Rehang the spare wheel cage to the vehicle.

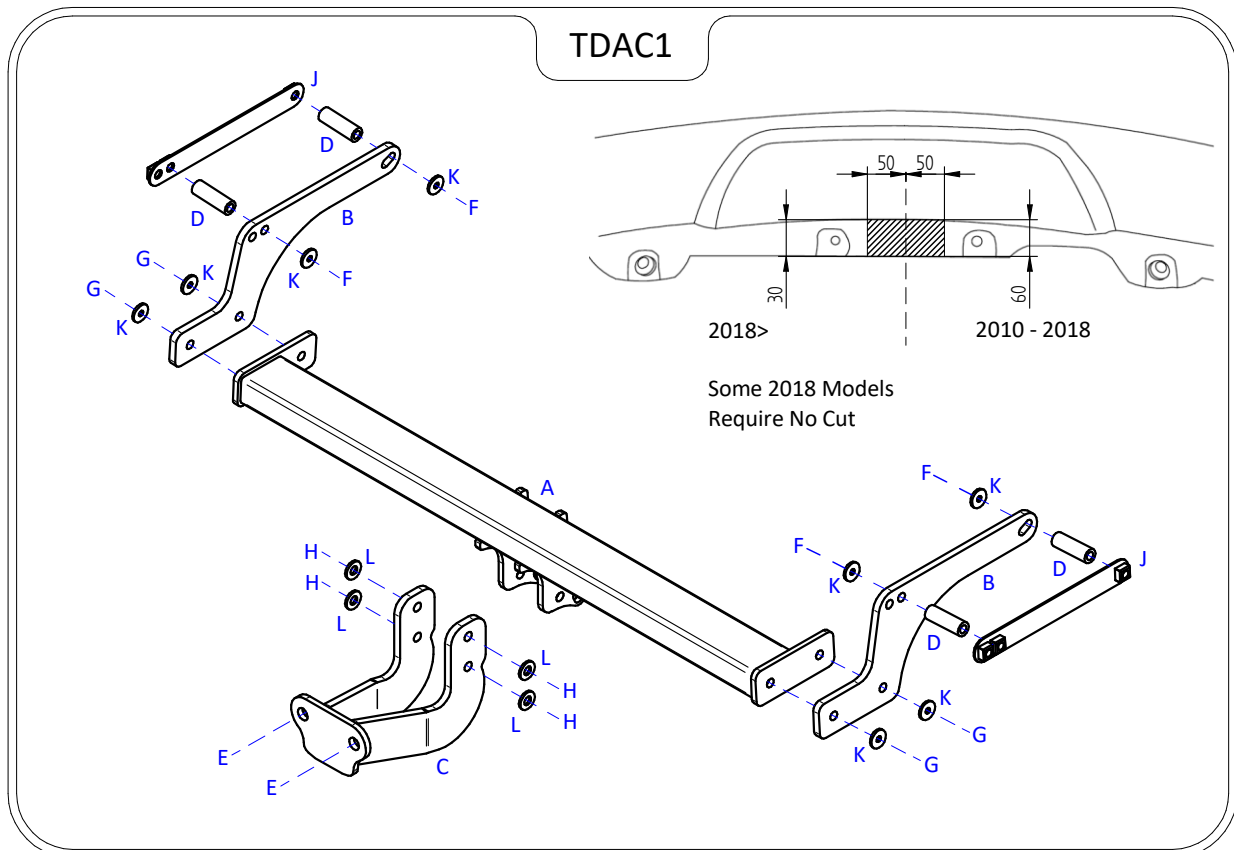

Note:

- Recommended Torque Setting for M12 Grade 10.9 -139 Nm. (For other Torque Settings see notes overleaf.)
- Nose load limits and vehicle manufacturers trailer / caravan weight limits must be observed.